



**SNIJRING FITTINGEN**  
**CUTTING RING FITTINGS**

# RVS SNIJRINGFITTINGEN

## STAINLESS STEEL CUTTING RING FITTINGS

Snijringfittings met BSP draad, volgens /

BSP threaded cutting ring fittings, according DIN 2353

Snijringen volgens / Cutting rings according DIN 3861

Ook leverbaar met NPT draad / NPT threaded available on request

### RECHTE KOPPELING | STRAIGHT UNION

| D  | TYPE | PN  | L1 | L2   | SW1 | SW3 | KG   |
|----|------|-----|----|------|-----|-----|------|
| 6  | L    | 500 | 44 | 10,0 | 12  | 14  | 0,06 |
| 8  | L    | 500 | 45 | 11,0 | 14  | 17  | 0,08 |
| 10 | L    | 500 | 48 | 13,0 | 17  | 19  | 0,11 |
| 12 | L    | 400 | 49 | 14,0 | 19  | 22  | 0,14 |
| 14 | S    | 630 | 63 | 22,0 | 24  | 27  | 0,30 |
| 15 | L    | 400 | 54 | 16,0 | 24  | 27  | 0,23 |
| 16 | S    | 630 | 65 | 21,0 | 27  | 30  | 0,35 |
| 18 | L    | 400 | 56 | 16,0 | 27  | 32  | 0,35 |
| 20 | S    | 420 | 73 | 23,0 | 32  | 36  | 0,58 |
| 22 | L    | 250 | 63 | 20,0 | 32  | 36  | 0,44 |
| 25 | S    | 420 | 84 | 26,0 | 41  | 46  | 0,95 |
| 28 | L    | 250 | 65 | 21,0 | 41  | 41  | 0,55 |
| 30 | S    | 420 | 88 | 27,0 | 46  | 50  | 1,12 |
| 35 | L    | 250 | 74 | 20,0 | 46  | 50  | 0,87 |
| 38 | S    | 420 | 99 | 29,0 | 55  | 60  | 1,69 |
| 42 | L    | 250 | 75 | 21,0 | 55  | 60  | 1,28 |

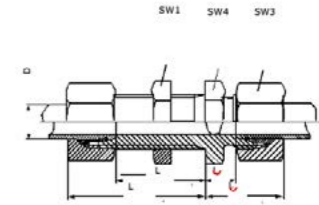
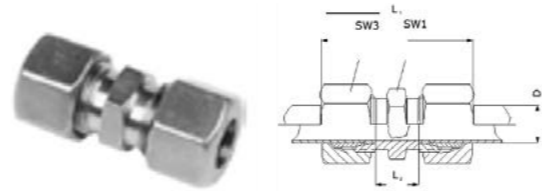

### RECHTE SCHOT KOPPELING | STRAIGHT UNION

| D  | TYPE | PN  | L1 | L2   | L4 | L5   | SW1 | SW3 | SW4 | KG   |
|----|------|-----|----|------|----|------|-----|-----|-----|------|
| 6  | L    | 500 | 22 | 7    | 42 | 27   | 17  | 14  | 17  | 0,06 |
| 8  | L    | 500 | 23 | 8    | 42 | 27   | 19  | 17  | 19  | 0,08 |
| 10 | L    | 500 | 25 | 10   | 43 | 28   | 22  | 19  | 22  | 0,11 |
| 12 | L    | 400 | 25 | 10   | 44 | 29   | 24  | 22  | 24  | 0,14 |
| 14 | S    | 630 | 35 | 17   | 50 | 32   | 30  | 27  | 30  | 0,3  |
| 15 | L    | 400 | 27 | 12   | 46 | 31   | 27  | 27  | 30  | 0,23 |
| 16 | S    | 630 | 35 | 16,5 | 50 | 31,5 | 32  | 30  | 32  | 0,35 |
| 18 | L    | 400 | 30 | 13,5 | 49 | 32,5 | 32  | 32  | 36  | 0,35 |
| 20 | S    | 420 | 39 | 17,5 | 55 | 33,5 | 41  | 36  | 41  | 0,58 |
| 22 | L    | 250 | 33 | 16,5 | 51 | 34,5 | 36  | 36  | 41  | 0,44 |
| 25 | S    | 420 | 44 | 20   | 59 | 35   | 46  | 46  | 46  | 0,95 |
| 28 | L    | 250 | 35 | 18,5 | 52 | 35,5 | 41  | 41  | 46  | 0,55 |
| 30 | S    | 420 | 48 | 21,5 | 64 | 37,5 | 50  | 50  | 50  | 1,12 |
| 35 | L    | 250 | 40 | 18,5 | 58 | 36,5 | 50  | 50  | 55  | 0,87 |
| 38 | S    | 420 | 53 | 22   | 68 | 37   | 65  | 60  | 65  | 1,69 |
| 42 | L    | 250 | 42 | 19   | 59 | 36   | 60  | 60  | 65  | 1,28 |

# RVS SNIJRINGFITTINGEN

## STAINLESS STEEL CUTTING RING FITTINGS

Snijringfittingen met BSP draad, volgens /

BSP threaded cutting ring fittings, according DIN 2353

Snijringen volgens / Cutting rings according DIN 3861

Ook leverbaar met NPT draad / NPT threaded available on request

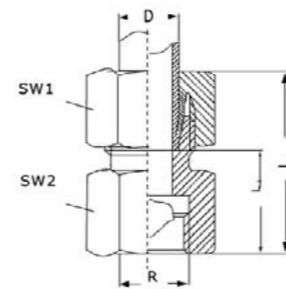

### RECHTE OPSCHROEF KOPPELING | FEMALE STRAIGHT CONNECTOR

| D x R       | TYPE | PN  | L1   | L2   | SW1 | SW2 | KG    |
|-------------|------|-----|------|------|-----|-----|-------|
| 6 x 1/4"    | L    | 500 | 39,0 | 24,0 | 19  | 14  | 0,048 |
| 6 x 1/8"    | L    | 500 | 34,0 | 19,0 | 14  | 14  | 0,027 |
| 8 x 1/4"    | L    | 500 | 39,0 | 24,0 | 19  | 17  | 0,050 |
| 10 x 1/4"   | L    | 500 | 40,0 | 25,0 | 19  | 19  | 0,060 |
| 12 x 1/2"   | L    | 400 | 46,0 | 29,0 | 27  | 22  | 0,106 |
| 12 x 1/4"   | L    | 400 | 40,0 | 25,0 | 19  | 22  | 0,068 |
| 12 x 3/8"   | L    | 400 | 41,0 | 26,0 | 22  | 22  | 0,088 |
| 14 x 1/2"   | S    | 630 | 50,0 | 32,0 | 27  | 27  | 0,148 |
| 15 x 1/2"   | L    | 400 | 46,0 | 31,0 | 24  | 27  | 0,113 |
| 15 x 3/8"   | L    | 400 | 42,0 | 27,0 | 27  | 27  | 0,114 |
| 16 x 1/2"   | S    | 630 | 50,0 | 31,5 | 27  | 30  | 0,175 |
| 18 x 1/2"   | L    | 400 | 47,0 | 30,5 | 27  | 32  | 0,151 |
| 18 x 3/8"   | L    | 400 | 44,0 | 27,5 | 27  | 32  | 0,168 |
| 20 x 1/2"   | S    | 420 | 52,0 | 30,5 | 32  | 36  | 0,248 |
| 20 x 3/4"   | S    | 420 | 56,0 | 34,5 | 36  | 36  | 0,300 |
| 20 x 3/8"   | S    | 420 | 49,0 | 27,5 | 32  | 36  | 0,245 |
| 22 x 3/4"   | L    | 250 | 52,0 | 35,5 | 27  | 36  | 0,270 |
| 25 x 1"     | S    | 420 | 62,0 | 37,5 | 41  | 46  | 0,466 |
| 28 x 1"     | L    | 250 | 55,0 | 38,0 | 36  | 41  | 0,311 |
| 30 x 1.1/4" | S    | 420 | 69,0 | 42,0 | 55  | 50  | 0,719 |
| 35 x 1.1/4" | L    | 250 | 63,0 | 41,0 | 41  | 50  | 0,588 |
| 38 x 1.1/2" | S    | 420 | 74,0 | 43,5 | 60  | 60  | 0,890 |
| 42 x 1.1/2" | L    | 250 | 65,0 | 42,5 | 55  | 60  | 0,760 |

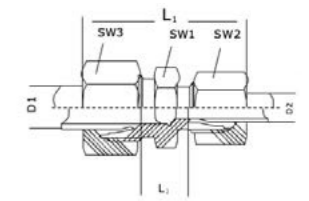

### RECHTE KOPPELING | STRAIGHT UNION

| D1 | D2 | TYPE | PN  | L1   | L2   | SW1 | SW2 | SW3 | KG   |
|----|----|------|-----|------|------|-----|-----|-----|------|
| 8  | 6  | L    | 500 | 45,5 | 11,0 | 14  | 14  | 17  | 0,05 |
| 10 | 6  | L    | 500 | 47,0 | 12,0 | 17  | 14  | 19  | 0,06 |
| 10 | 8  | L    | 500 | 47,0 | 12,0 | 17  | 17  | 19  | 0,06 |
| 12 | 6  | L    | 400 | 48,0 | 13,0 | 19  | 14  | 22  | 0,06 |
| 12 | 8  | L    | 400 | 48,0 | 13,0 | 19  | 17  | 22  | 0,07 |
| 12 | 10 | L    | 400 | 49,5 | 14,0 | 19  | 19  | 22  | 0,08 |
| 14 | 10 | S    | 630 | 60,0 | 20,5 | 24  | 22  | 27  | 0,13 |
| 14 | 12 | S    | 630 | 60,0 | 20,5 | 24  | 24  | 27  | 0,17 |
| 15 | 6  | L    | 400 | 50,5 | 14,0 | 24  | 14  | 27  | 0,10 |
| 15 | 8  | L    | 400 | 50,5 | 14,0 | 24  | 17  | 27  | 0,11 |
| 15 | 10 | L    | 400 | 52,0 | 15,0 | 24  | 19  | 27  | 0,11 |
| 15 | 12 | L    | 400 | 52,0 | 15,0 | 24  | 22  | 27  | 0,12 |
| 16 | 10 | S    | 630 | 60,5 | 20,0 | 27  | 22  | 30  | 0,19 |
| 16 | 12 | S    | 630 | 60,5 | 20,0 | 27  | 24  | 30  | 0,19 |
| 16 | 14 | S    | 630 | 63,5 | 21,5 | 27  | 27  | 30  | 0,22 |
| 18 | 8  | L    | 400 | 52,0 | 14,5 | 27  | 27  | 32  | 0,12 |
| 18 | 10 | L    | 400 | 53,5 | 15,5 | 27  | 19  | 32  | 0,15 |
| 18 | 12 | L    | 400 | 53,5 | 15,5 | 27  | 22  | 32  | 0,16 |
| 18 | 15 | L    | 400 | 56,5 | 16,5 | 27  | 27  | 32  | 0,18 |
| 20 | 10 | S    | 420 | 65,5 | 22,0 | 32  | 22  | 36  | 0,27 |
| 20 | 12 | S    | 420 | 65,5 | 22,0 | 32  | 24  | 36  | 0,28 |
| 20 | 14 | S    | 420 | 68,5 | 23,0 | 32  | 27  | 36  | 0,30 |
| 20 | 16 | S    | 420 | 69,5 | 23,0 | 32  | 30  | 36  | 0,32 |
| 22 | 12 | L    | 250 | 57,0 | 17,5 | 32  | 22  | 36  | 0,20 |
| 22 | 15 | L    | 250 | 59,0 | 18,5 | 32  | 27  | 36  | 0,22 |
| 22 | 18 | L    | 250 | 60,0 | 18,0 | 32  | 32  | 36  | 0,25 |
| 25 | 16 | S    | 420 | 74,5 | 25,5 | 41  | 30  | 46  | 0,55 |
| 25 | 20 | S    | 420 | 79,0 | 25,5 | 41  | 36  | 46  | 0,56 |
| 28 | 10 | L    | 250 | 60,0 | 20,5 | 41  | 19  | 41  | 0,25 |
| 28 | 15 | L    | 250 | 62,5 | 19,0 | 41  | 27  | 41  | 0,30 |
| 28 | 18 | L    | 250 | 61,0 | 19,0 | 41  | 32  | 41  | 0,31 |
| 28 | 22 | L    | 250 | 64,0 | 21,0 | 41  | 36  | 41  | 0,31 |
| 30 | 20 | S    | 420 | 81,5 | 26,0 | 46  | 36  | 50  | 0,78 |
| 30 | 25 | S    | 420 | 86,0 | 26,5 | 46  | 46  | 50  | 0,80 |
| 35 | 28 | L    | 250 | 70,5 | 21,0 | 46  | 41  | 50  | 0,46 |
| 38 | 30 | S    | 420 | 95,5 | 29,5 | 55  | 50  | 60  | 0,87 |

# RVS SNIJRINGFITTINGEN

## STAINLESS STEEL CUTTING RING FITTINGS

Snijringfittingen met BSP draad, volgens /

BSP threaded cutting ring fittings, according DIN 2353

Snijringen volgens / Cutting rings according DIN 3861

Ook leverbaar met NPT draad / NPT threaded available on request

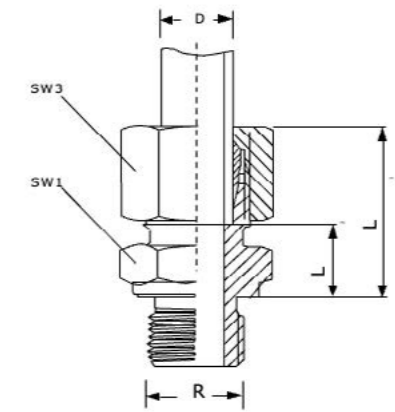

### RECHTE INSCHROEF KOPPELING | STRAIGHT MALE CONNECTOR

| D x R     | TYPE  | PN  | L1   | L2   | SW1 | SW2 | KG    |
|-----------|-------|-----|------|------|-----|-----|-------|
| 6 x 1/8"  | CYL L | 500 | 23,0 | 8,5  | 14  | 14  | 0,026 |
| 6 x 1/4"  | CYL L | 500 | 27,0 | 9,0  | 17  | 14  | 0,038 |
| 6 x 3/8"  | CYL L | 500 | 27,0 | 11,5 | 22  | 14  | 0,052 |
| 6 x 1/2"  | CYL L | 500 | 29,0 | 12,0 | 27  | 14  | 0,074 |
| 8 x 1/8"  | CYL L | 500 | 26,0 | 9,5  | 14  | 17  | 0,034 |
| 8 x 1/4"  | CYL L | 500 | 25,0 | 10,0 | 19  | 17  | 0,044 |
| 8 x 3/8"  | CYL L | 500 | 28,5 | 11,5 | 22  | 17  | 0,062 |
| 8 x 1/2"  | CYL L | 500 | 28,5 | 13,0 | 27  | 17  | 0,092 |
| 10 x 1/8" | CYL L | 500 | 27,5 | 11,0 | 17  | 19  |       |
| 10 x 1/4" | CYL L | 500 | 26,0 | 11,0 | 19  | 19  | 0,050 |
| 10 x 3/8" | CYL L | 500 | 30,5 | 12,5 | 22  | 19  | 0,066 |
| 10 x 1/2" | CYL L | 500 | 32,5 | 13,0 | 27  | 19  | 0,094 |
| 12 x 1/8" | CYL L | 400 | 29,0 | 11,0 | 19  | 22  |       |
| 12 x 1/4" | CYL L | 400 | 30,0 | 12,0 | 19  | 22  | 0,062 |
| 12 x 3/8" | CYL L | 400 | 27,0 | 12,5 | 22  | 22  | 0,072 |
| 12 x 1/2" | CYL L | 400 | 31,0 | 13,0 | 27  | 22  | 0,102 |
| 14 x 1/4" | CYL S | 630 |      | 19,0 | 32  | 27  | 0,212 |
| 14 x 3/8" | CYL S | 630 |      | 17,0 | 24  | 27  | 0,130 |
| 14 x 1/2" | CYL S | 630 | 37,0 | 19,0 | 27  | 27  | 0,158 |
| 15 x 1/4" | CYL L | 400 | 32,0 | 13,0 | 24  | 27  | 0,094 |
| 15 x 3/8" | CYL L | 400 | 31,0 | 13,5 | 24  | 27  | 0,102 |
| 15 x 1/2" | CYL L | 400 | 29,0 | 14,0 | 27  | 27  | 0,122 |
| 15 x 3/4" | CYL L | 400 | 32,5 | 15,0 | 32  | 27  | 0,170 |
| 16 x 1/4" | CYL S | 630 | 39,0 | 20,5 | 32  | 30  | 0,230 |
| 16 x 3/8" | CYL S | 630 |      | 18,0 | 27  | 30  | 0,166 |
| 16 x 1/2" | CYL S | 630 | 37,0 | 18,5 | 27  | 30  | 0,164 |
| 18 x 3/8" | CYL L | 400 | 31,0 | 12,5 | 27  | 32  | 0,138 |

| D x R       | TYPE  | PN  | L1   | L2   | SW1 | SW2 | KG    |
|-------------|-------|-----|------|------|-----|-----|-------|
| 18 x 1/2"   | CYL L | 400 | 31,0 | 14,5 | 27  | 32  | 0,144 |
| 18 x 3/4"   | CYL L | 400 | 34,0 | 14,5 | 32  | 32  | 0,184 |
| 18 x 1"     | CYL L | 400 |      | 16,5 | 41  | 32  | 0,290 |
| 20 x 1/2"   | CYL S | 420 |      | 20,5 | 32  | 36  | 0,256 |
| 20 x 3/4"   | CYL S | 420 | 42,0 | 20,5 | 32  | 36  | 0,272 |
| 20 x 1"     | CYL S | 420 |      | 22,5 | 41  | 36  | 0,398 |
| 20 x 1 1/4" | CYL S | 420 |      | 22,5 | 50  | 36  | 0,576 |
| 20 x 1 1/2" | CYL S | 420 | 47,0 | 25,5 | 55  | 36  | 0,722 |
| 22 x 1/2"   | CYL L | 250 | 37,0 | 16,5 | 32  | 36  | 0,192 |
| 22 x 3/4"   | CYL L | 250 | 33,0 | 16,5 | 32  | 36  | 0,200 |
| 22 x 1"     | CYL L | 250 | 38,0 | 17,5 | 41  | 36  | 0,286 |
| 25 x 1/2"   | CYL S | 420 |      | 23,0 | 41  | 46  | 0,456 |
| 25 x 3/4"   | CYL S | 420 |      | 23,0 | 41  | 46  | 0,480 |
| 25 x 1"     | CYL S | 420 | 47,0 | 23,0 | 41  | 46  | 0,498 |
| 25 x 1 1/4" | CYL S | 420 |      | 23,5 | 50  | 46  | 0,676 |
| 25 x 1 1/2" | CYL S | 430 | 50,0 | 26,0 | 55  | 46  | 0,882 |
| 28 x 1/2"   | CYL L | 250 |      | 17,5 | 41  | 41  | 0,250 |
| 28 x 3/4"   | CYL L | 250 | 38,0 | 17,5 | 41  | 41  | 0,272 |
| 28 x 1"     | CYL L | 250 | 34,0 | 17,5 | 41  | 41  | 0,280 |
| 28 x 1 1/4" | CYL L | 250 |      | 18,5 | 50  | 41  | 0,438 |
| 30 x 1"     | CYL S | 420 | 50,0 | 23,5 | 46  | 50  | 0,592 |
| 30 x 1 1/4" | CYL S | 420 | 50,0 | 23,0 | 50  | 50  | 0,680 |
| 30 x 1 1/2" | CYL S | 420 | 50,0 | 26,0 | 55  | 50  | 0,824 |
| 35 x 1 1/4" | CYL L | 250 | 39,0 | 17,5 | 50  | 50  | 0,454 |
| 38 x 1 1/4" | CYL S | 420 |      | 23,0 | 55  | 60  | 0,950 |
| 38 x 1 1/2" | CYL S | 420 | 57,0 | 26,0 | 55  | 60  | 0,954 |
| 42 x 1 1/2" | CYL L | 250 | 47,0 | 19,0 | 55  | 60  | 0,618 |

# RVS SNIJRINGFITTINGEN

## STAINLESS STEEL CUTTING RING FITTINGS

Snijringfittingen met BSP draad, volgens /

BSP threaded cutting ring fittings, according DIN 2353

Snijringen volgens / Cutting rings according DIN 3861

Ook leverbaar met NPT draad / NPT threaded available on request

### KNIE KOPPELING | UNION ELBOW

| D  | TYPE | PN  | L1 | L2   | SW1 | SW3 | KG   |
|----|------|-----|----|------|-----|-----|------|
| 6  | L    | 500 | 44 | 10,0 | 12  | 14  | 0,06 |
| 8  | L    | 500 | 45 | 11,0 | 14  | 17  | 0,08 |
| 10 | L    | 500 | 48 | 13,0 | 17  | 19  | 0,11 |
| 12 | L    | 400 | 49 | 14,0 | 19  | 22  | 0,14 |
| 14 | S    | 630 | 63 | 22,0 | 24  | 27  | 0,30 |
| 15 | L    | 400 | 54 | 16,0 | 24  | 27  | 0,23 |
| 16 | S    | 630 | 65 | 21,0 | 27  | 30  | 0,35 |
| 18 | L    | 400 | 56 | 16,0 | 27  | 32  | 0,35 |
| 20 | S    | 420 | 73 | 23,0 | 32  | 36  | 0,58 |
| 22 | L    | 250 | 63 | 20,0 | 32  | 36  | 0,44 |
| 25 | S    | 420 | 84 | 26,0 | 41  | 46  | 0,95 |
| 28 | L    | 250 | 65 | 21,0 | 41  | 41  | 0,55 |
| 30 | S    | 420 | 88 | 27,0 | 46  | 50  | 1,12 |
| 35 | L    | 250 | 74 | 20,0 | 46  | 50  | 0,87 |
| 38 | S    | 420 | 99 | 29,0 | 55  | 60  | 1,69 |
| 42 | L    | 250 | 75 | 21,0 | 55  | 60  | 1,28 |

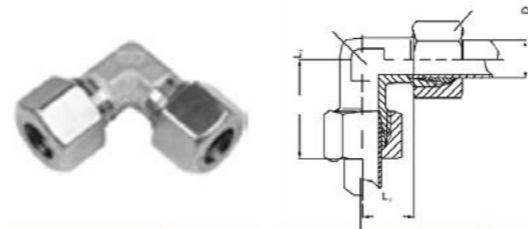

### T-KOPPELING | UNION TEE

| D  | TYPE | PN  | L1 | L2   | SW1 | SW3 | KG    |
|----|------|-----|----|------|-----|-----|-------|
| 6  | L    | 500 | 27 | 12,0 | 12  | 14  | 0,002 |
| 8  | L    | 500 | 29 | 14,0 | 12  | 17  | 0,002 |
| 10 | L    | 500 | 30 | 15,0 | 14  | 19  | 0,003 |
| 12 | L    | 400 | 32 | 17,0 | 17  | 22  | 0,003 |
| 15 | L    | 400 | 36 | 21,0 | 19  | 27  | 0,004 |
| 18 | L    | 400 | 40 | 23,5 | 24  | 32  | 0,005 |
| 22 | L    | 250 | 44 | 27,5 | 27  | 36  | 0,006 |
| 28 | L    | 250 | 47 | 30,5 | 36  | 41  | 0,008 |
| 35 | L    | 250 | 56 | 34,5 | 41  | 50  | 0,017 |
| 42 | L    | 250 | 63 | 40,0 | 50  | 60  | 0,021 |
| 14 | S    | 630 | 40 | 22,0 | 19  | 27  | 0,004 |
| 16 | S    | 630 | 43 | 24,4 | 24  | 30  | 0,004 |
| 20 | S    | 420 | 48 | 26,5 | 27  | 36  | 0,009 |
| 25 | S    | 420 | 54 | 30,0 | 36  | 46  | 0,011 |
| 30 | S    | 420 | 62 | 35,5 | 41  | 50  | 0,015 |
| 38 | S    | 420 | 72 | 41,0 | 50  | 60  | 0,019 |

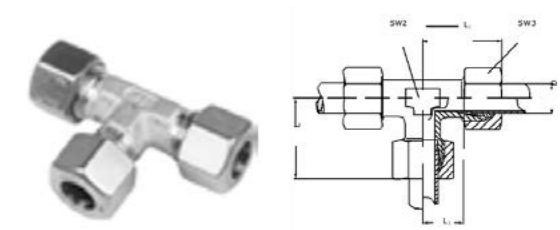

# RVS SNIJRINGFITTINGEN

## STAINLESS STEEL CUTTING RING FITTINGS

Snijringfittings met BSP draad, volgens /  
BSP threaded cutting ring fittings, according  
DIN 2353

Snijringen volgens /  
Cutting rings according DIN 3861

Ook leverbaar met NPT draad /  
NPT threaded available on request

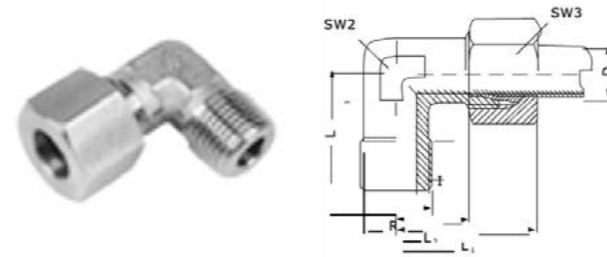

### RECHTE INSCHROEF KOPPELING | STRAIGHT MALE CONNECTOR

| D x R       | TYPE | PN | L1  | L2   | L3   | I  | SW2 | SW3 | KG |      |
|-------------|------|----|-----|------|------|----|-----|-----|----|------|
| 6 x 1/8"    | CON  | L  | 500 | 27,0 | 12,0 | 20 | 8   | 12  | 14 | 0,03 |
| 6 x 1/4"    | CON  | L  | 500 | 27,0 | 12,0 | 26 | 12  | 12  | 14 | 0,06 |
| 8 x 1/8"    | CON  | L  | 500 | 29,0 | 14,0 | 26 | 8   | 12  | 17 | 0,05 |
| 8 x 1/4"    | CON  | L  | 500 | 29,0 | 14,0 | 26 | 12  | 12  | 17 | 0,06 |
| 8 x 3/8"    | CON  | L  | 500 | 32,0 | 17,0 | 28 | 12  | 14  | 17 | 0,08 |
| 8 x 1/2"    | CON  | L  | 500 | 34,5 | 19,5 | 30 | 14  | 17  | 17 | 0,10 |
| 10 x 1/4"   | CON  | L  | 500 | 30,0 | 15,0 | 27 | 12  | 14  | 19 | 0,06 |
| 10 x 3/8"   | CON  | L  | 500 | 30,0 | 15,0 | 28 | 12  | 14  | 19 | 0,06 |
| 10 x 1/2"   | CON  | L  | 500 | 37,0 | 21,0 | 33 | 14  | 17  | 19 | 0,09 |
| 12 x 1/4"   | CON  | L  | 400 | 32,0 | 17,5 | 27 | 12  | 17  | 22 | 0,07 |
| 12 x 3/8"   | CON  | L  | 400 | 32,0 | 17,5 | 28 | 12  | 17  | 22 | 0,08 |
| 12 x 1/2"   | CON  | L  | 400 | 32,0 | 17,5 | 34 | 14  | 17  | 22 | 0,11 |
| 14 x 3/8"   | CON  | S  | 630 | 40,0 | 22,0 | 30 | 12  | 19  | 27 | 0,15 |
| 14 x 1/2"   | CON  | S  | 630 | 40,0 | 22,0 | 32 | 14  | 19  | 27 | 0,16 |
| 15 x 3/8"   | CON  | L  | 400 | 36,0 | 21,0 |    | 12  | 19  | 27 | 0,12 |
| 15 x 1/2"   | CON  | L  | 400 | 36,0 | 21,0 | 34 | 14  | 19  | 27 | 0,13 |
| 16 x 1/2"   | CON  | S  | 630 | 43,0 | 24,5 | 32 | 14  | 24  | 30 | 0,20 |
| 18 x 1/2"   | CON  | L  | 400 | 40,0 | 23,5 | 36 | 14  | 24  | 32 | 0,19 |
| 20 x 3/4"   | CYL  | S  | 420 | 48,0 | 26,5 | 26 | 16  | 27  | 36 | 0,33 |
| 22 x 3/4"   | CYL  | L  | 250 | 44,0 | 27,5 | 26 | 16  | 27  | 36 | 0,27 |
| 25 x 1"     | CYL  | S  | 420 | 54,0 | 30,0 | 30 | 18  | 36  | 46 | 0,63 |
| 28 x 1"     | CYL  | L  | 250 | 47,0 | 30,5 | 30 | 18  | 36  | 41 | 0,42 |
| 30 x 1.1/4" | CYL  | L  | 250 | 62,0 | 35,5 | 34 | 20  | 41  | 50 | 0,87 |
| 35 x 1.1/4" | CYL  | L  | 250 | 56,0 | 34,5 | 34 | 20  | 41  | 50 | 0,63 |
| 38 x 1.1/2" | CYL  | S  | 420 | 72,0 | 41,0 | 39 | 22  | 50  | 60 | 1,23 |
| 42 x 1.1/2" | CYL  | S  | 250 | 63,0 | 40,0 | 39 | 22  | 50  | 60 | 0,95 |

### KAP KOPPELING | KAP UNION

| D  | TYPE | PN  | L1 | SW1 | SW2 | KG    |
|----|------|-----|----|-----|-----|-------|
| 6  | L    | 500 | 17 | 14  | 12  | 0,022 |
| 8  | L    | 500 | 17 | 17  | 14  | 0,030 |
| 10 | L    | 500 | 17 | 19  | 17  | 0,038 |
| 12 | L    | 400 | 17 | 22  | 19  | 0,050 |
| 15 | L    | 400 | 18 | 27  | 24  | 0,084 |
| 18 | L    | 400 | 19 | 32  | 27  | 0,124 |
| 22 | L    | 250 | 21 | 36  | 32  | 0,166 |
| 28 | L    | 250 | 22 | 41  | 41  | 0,238 |
| 35 | L    | 250 | 25 | 50  | 46  | 0,356 |
| 42 | L    | 250 | 27 | 60  | 55  | 0,556 |
| 14 | S    | 630 | 24 | 27  | 24  | 0,118 |
| 16 | S    | 420 | 24 | 30  | 27  | 0,142 |
| 20 | S    | 420 | 28 | 36  | 32  | 0,236 |
| 25 | S    | 420 | 32 | 46  | 41  | 0,448 |
| 30 | S    | 420 | 34 | 50  | 46  | 0,540 |
| 38 | S    | 420 | 39 | 65  | 55  | 0,870 |

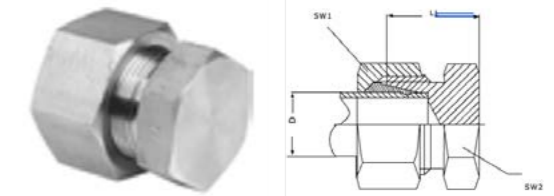

# RVS SNIJRINGFITTINGEN

## STAINLESS STEEL CUTTING RING FITTINGS

Snijringfittings met BSP draad, volgens /

BSP threaded cutting ring fittings, according DIN 2353

Snijringen volgens / Cutting rings according DIN 3861

Ook leverbaar met NPT draad / NPT threaded available on request

### SNIJRING | CUTTING RING

| D  | TYPE | PN  | L1   | KG    |
|----|------|-----|------|-------|
| 6  | L    | 500 | 9,5  | 0,002 |
| 8  | L    | 500 | 9,5  | 0,002 |
| 10 | L    | 500 | 10,0 | 0,003 |
| 12 | L    | 400 | 10,0 | 0,003 |
| 14 | S    | 630 | 10,0 | 0,004 |
| 15 | L    | 400 | 10,0 | 0,004 |
| 16 | S    | 630 | 10,5 | 0,004 |
| 18 | L    | 400 | 10,0 | 0,005 |
| 20 | S    | 420 | 12,5 | 0,009 |
| 22 | L    | 250 | 10,5 | 0,006 |
| 25 | S    | 420 | 12,5 | 0,011 |
| 28 | L    | 250 | 10,5 | 0,008 |
| 30 | S    | 420 | 13,0 | 0,015 |
| 35 | L    | 250 | 13,0 | 0,017 |
| 38 | S    | 420 | 13,5 | 0,019 |
| 42 | L    | 250 | 13,5 | 0,021 |

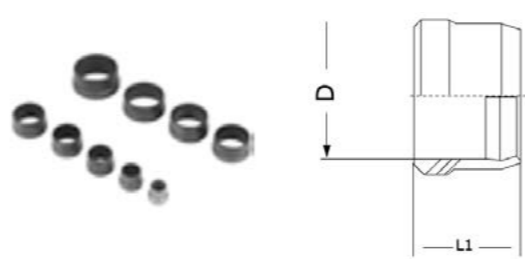

### VERSTEVIINGSHULS | REINFORCING RING

| D  | TYPE | PN   | L1   |
|----|------|------|------|
| 4  | 3,8  | 2,5  | 17,0 |
| 5  | 4,8  | 3,5  | 17,0 |
| 6  | 5,8  | 4,5  | 14,0 |
| 7  | 6,8  | 5,5  | 17,0 |
| 8  | 7,8  | 6,5  | 15,5 |
| 9  | 8,8  | 7,5  | 17,0 |
| 10 | 9,8  | 8,5  | 15,5 |
| 11 | 10,8 | 9,5  | 17,0 |
| 12 | 11,8 | 10,5 | 17,0 |
| 13 | 12,8 | 11,5 | 17,0 |
| 14 | 13,8 | 12,0 | 17,0 |
| 15 | 14,8 | 13,0 | 18,0 |
| 16 | 15,8 | 14,0 | 18,0 |
| 17 | 16,8 | 15,0 | 20,0 |
| 18 | 17,8 | 16,0 | 20,0 |
| 19 | 18,8 | 17,0 | 20,0 |
| 20 | 19,8 | 18,0 | 20,0 |
| 22 | 21,8 | 20,0 | 24,0 |
| 24 | 23,8 | 22,0 | 23,5 |
| 25 | 24,8 | 23,0 | 23,5 |
| 31 | 30,8 | 28,0 | 26,5 |
| 32 | 31,8 | 29,5 | 26,5 |
| 33 | 32,8 | 30,0 | 26,5 |
| 38 | 37,8 | 35,0 | 26,5 |

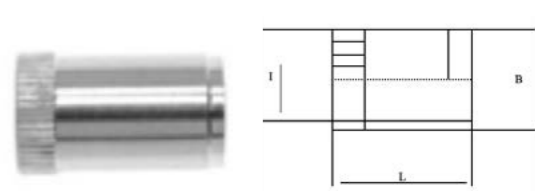

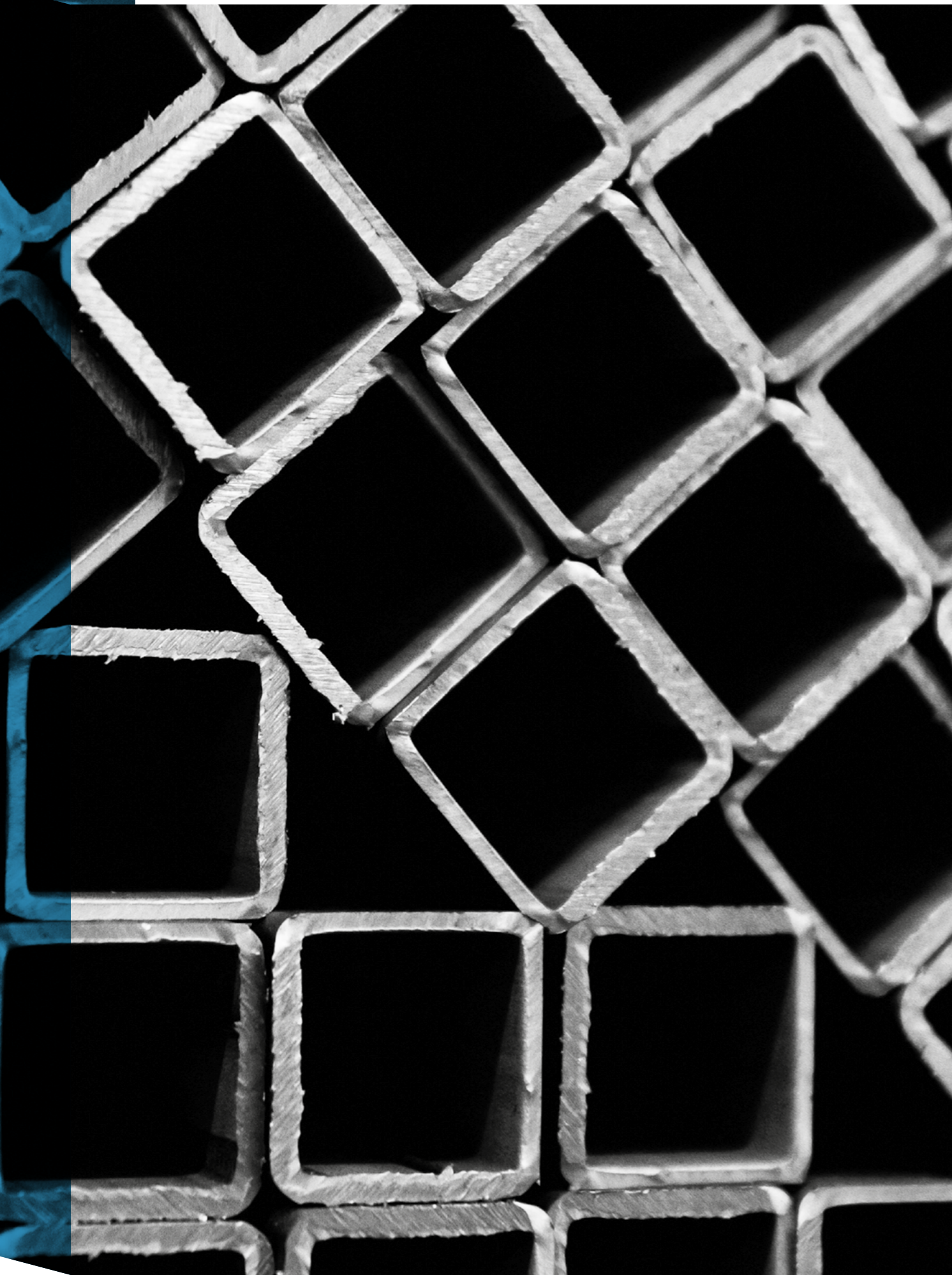

# CONTACT

Benieuwd naar wat we voor jou kunnen betekenen? Onze medewerkers staan voor u klaar. Neem geheel vrijblijvend contact met ons op.



**Bel 0515 580 880**

Op werkdagen van 08:00 - 17:00



**Stuur een Whatsapp**

0515 580 880



**Stuur een E-mail**

info@nedinox.nl



**Nedinox B.V.**

De Marne 16-18 | 8701 PT | Bolsward





Nedinox B.V. | De marne 16 - 18 | 8701 PT Bolsward  
+31 515 580 880 | [info@nedinox.nl](mailto:info@nedinox.nl) | [nedinox.nl](http://nedinox.nl)